

压式结构传感器

尺寸及量程 / Size and Capacity

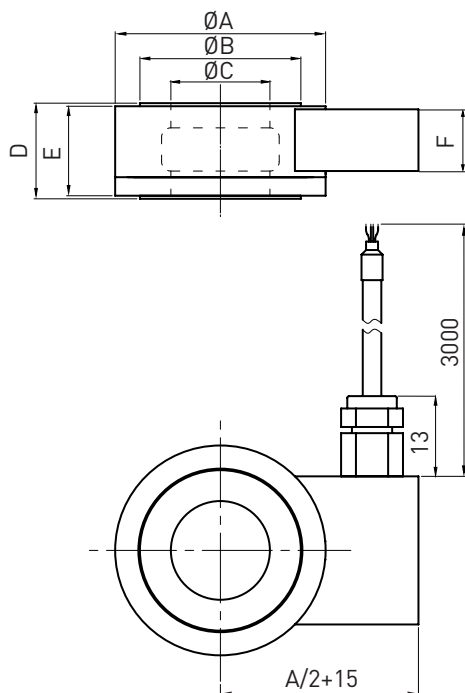

SIZE(mm)	A	B	C	D	E	F	材料 / Material	重量/Weight
0.3/0.5/1/2	34	24	16	15	14	10	不锈钢 Stainless steel	0.1kg
5/10/15/20	69	54	32	50	49	30		1.1kg
10/20/30/45	95	78	50	50	49	30		1.9kg

技术参数 / Technical Parameters

参数	Specifications	技术指标/Technique
输出灵敏度	Rated output	1.0 ± 10% mV / V
零点输出	Zero balance	± 2% F.S.
非线性	Non-linearity	2% F.S.
滞后	Hysteresis	2% F.S.
重复性	Repeatability	0.5% F.S.
蠕变 (30分钟)	Creep (30min)	0.5% F.S.
温度灵敏度漂移	Temp. effect on output	0.05% F.S. / 10°C
零点温度漂移	Temp. effect on zero	0.05% F.S. / 10°C
输入电阻	Input impedance	385 ± 30 Ω
输出电阻	Output impedance	350 ± 5 Ω
绝缘电阻	Insulation	≥5000M Ω / 100VDC
激励电压	Recommended excitation	5V
最大激励电压	Maximum excitation	10V
温度补偿范围	Compensated temp. range	-10 ~ 60°C
工作温度范围	Operation temp. range	-20 ~ 80°C
安全超载	Safe overload	150% F.S.
极限超载	Ultimate overload	200% F.S.
电缆线尺寸	Cable size	Ø3 × 3000 mm
防护等级	Protection class	IP65
连接方式	Cable color code	Input: Red(+) Black(-); Output: Green(+) White(-); 输入: 红 (+) 黑 (-); 输出: 绿 (+) 白 (-);



特点和用途 / Features & Applications

- 垫圈式环形不锈钢材料传感器
- 形变量小
- 可定制, IP65
- 适用于螺钉及杆件的张力测试、挤压力测试、组装机测试及其他压力测试
- Washer type load cell made of stainless steel
- Low deflection
- Customizable, IP65
- Suitable for tension measurement of screw bolts and rod pieces, extrusion force test, assemble pressure test and other pressure test

受力方式 / Load Direction

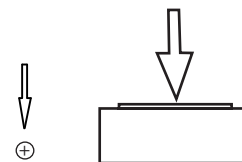

接线图 / Schematic Wiring Diagram

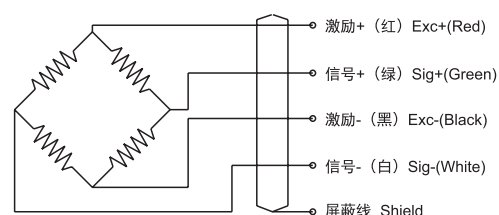

注: 屏蔽线不与弹性体相连。
Note: Cable shield is not connected to element.

Model:F6804